

GRAN TURISMO 41



GRAN TURISMO 41

INTRODUCTION

Technical Data

Side Elevation

Layout

Concept

EXTERIOR

Profile

Exterior USP's

Hard top

Aft Cockpit Plan

Bow sunbed

Cockpit

Helm Station

INTERIOR

Wheelhouse

Galley

Master room

Guest room

Day head

TECHNICAL

Trucking Dimensions

Technical Equipments

Technical Equipments

CARACTÉRISTIQUES

CARACTÉRISTIQUES PRINCIPALES	DATA	
Overall length	12,67m	41'6"
Hull length	11,5m	37'7"
Hull max beam	3,85m	12'6"
Max draft	0,94m	3'1"
Max air draft	4,20m	13'9"
Light displacement (with 2x300hp)	7 959 kg	17,547 lbs
Full load displacement (with 2x300hp)	11 013 kg	24,280 lbs
Berths	5	
Category CE	B10 / C10 / D10	
Architecte	Beneteau Power	
Designer	Andreani Design	

CAPACITY



Fuel

650 L (2x325L)
172 US gal (2x86 US gal)



Water

200 L
53 US gal



Water hot tank

40 L
11 US gal



Black water tank

80 L
22 US gal

MOTORISATION / PERFORMANCES



Volvo – Z drive

2 x 300 CV / 220 KW
2 x 380CV / 279 KW



Speed Max

32 kts – 2 x 300 CV
37 kts – 2 x 380CV

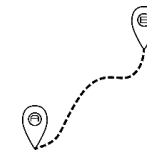

Autonomy

178nm (@25kts) – 2x300cv
175nm (@25kts) – 2x380cv

SIDE
ELEVATION

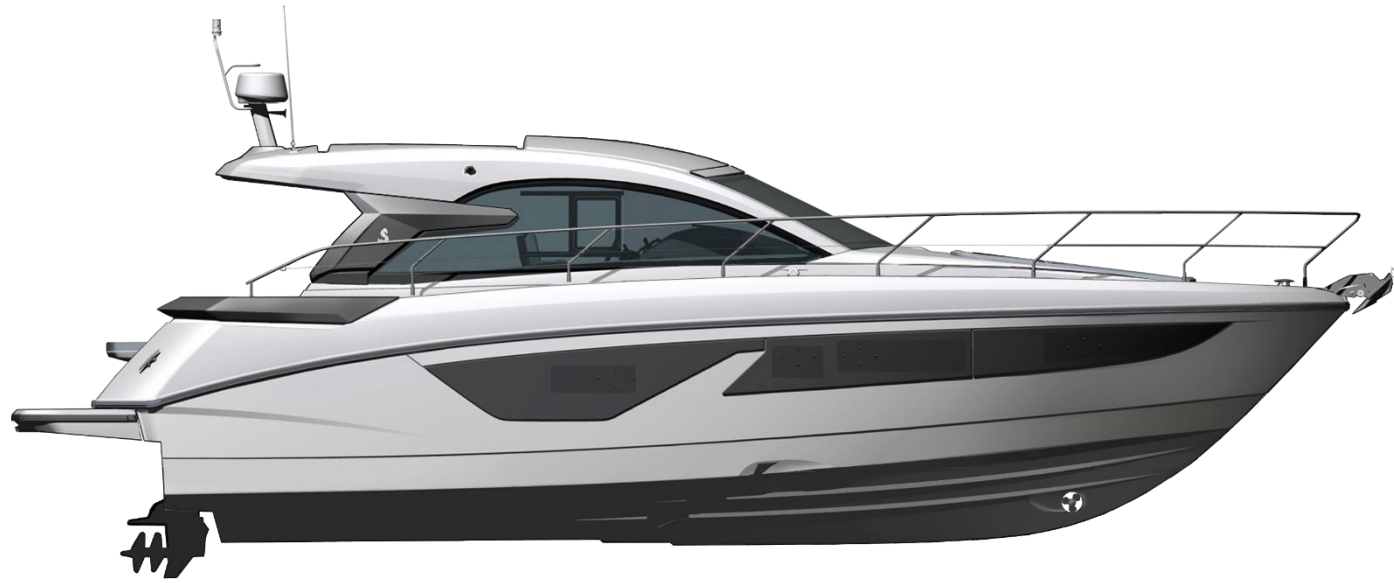

GRAN
TURISMO 41



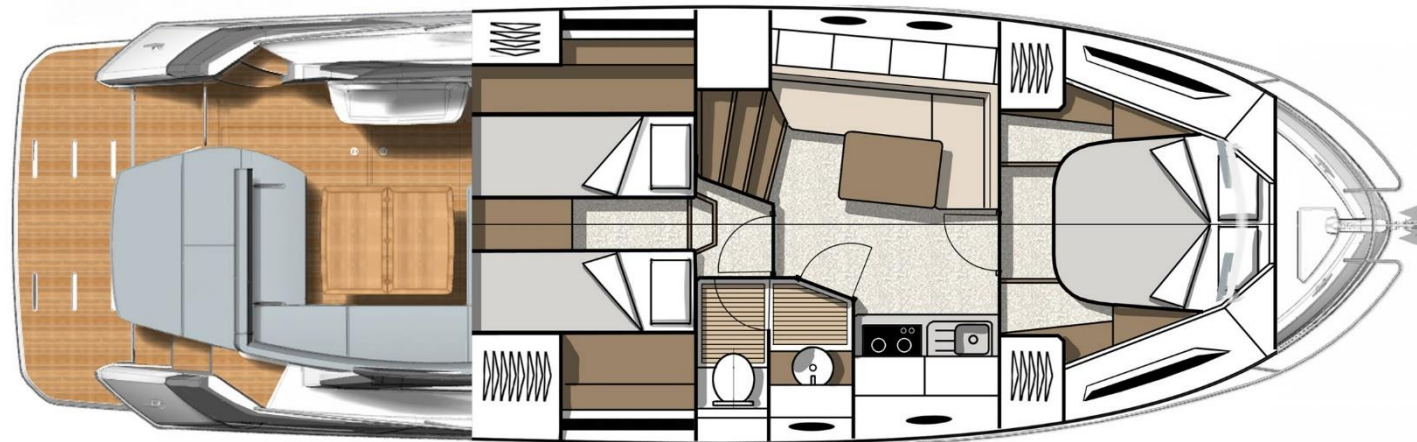
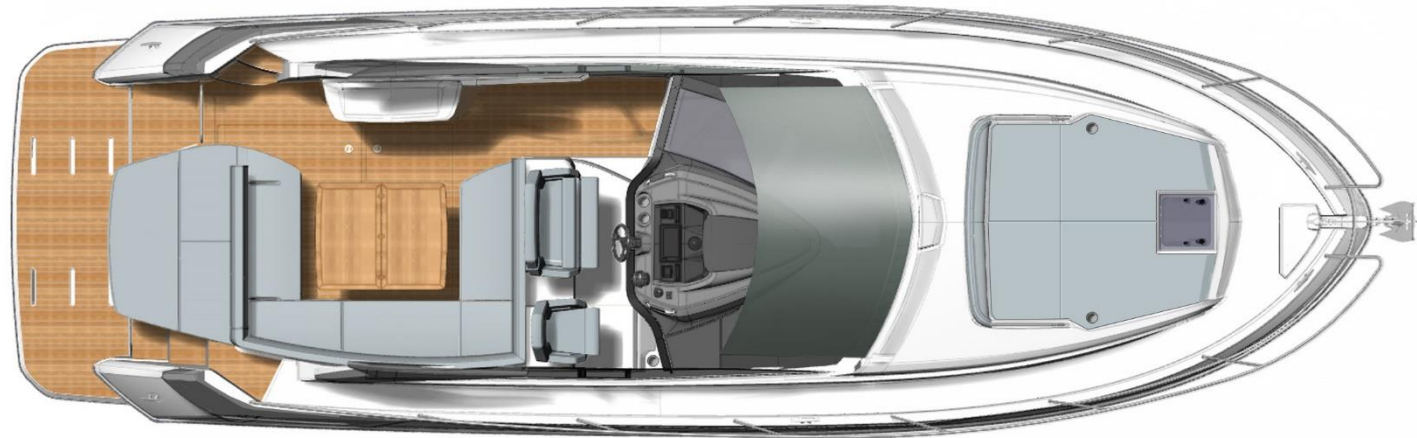

GRAN TURISMO 41

GRAN TURISMO - KEY SELLING POINTS

CONCEPT

Design evolution

Whilst remaining true to the DNA of the Gran Turismo family the 41 advances the innovation required to meet clients evolving demands. The 41 introduces a number of improvements. Its modern and sporty design includes very large hull glazing to bring light to the lower deck. The deck plan has been modified for more comfort and conviviality. A large sunbed facing the sea is overlooking the electric platform. The cockpit secured by a gate offers a large space for relaxation and dining with a large U-shaped saloon and a double foldable table, with a kitchen for outdoor dining. The cockpit is extremely spacious, with two seats and good visibility offered by the one-piece windshield. The optional Zipwake automatic trim is available, as well as a joystick and a bow thruster, which will be appreciated to park the Gran Turismo 41.

Air Step - optimum hull

This generation Gran Turismo hull builds on Beneteau seaworthy heritage in combination with sensible consumption and performance. Gran Turismo 41 allow comfortable passage making with the large fuel and water tanks giving great autonomy. The air step hull offers more sensations in terms of speed and acceleration while improving the safety, comfort and performance.

Easy circulation around the boat

The design of the Gran Turismo 41 provides easy circulation, space and functionality to respond to many requirements. Four berths in two cabins, with a further berth in the saloon in combination with generous storage, and features in all areas allows grandchildren to grandparents and friends to embark on many memorable voyages...

- Electric sunroof and electric platform
- Two large and comfortable sunbeds – aft / deck
- Cockpit u-shaped sofa – giving 360° views and conviviality.
- Large and intuitive helm station
- Spacious and bright lower deck

A view from the main deck of a luxury yacht, showing white seating, a wooden table, and the ocean. The deck is finished with teak planking. In the background, the yacht's helm station is visible. The text "KEY SELLING POINTS" is overlaid in white on a semi-transparent dark blue background.

KEY SELLING POINTS

MAIN DECK

GRAN TURISMO 41

Exterior -Key Points

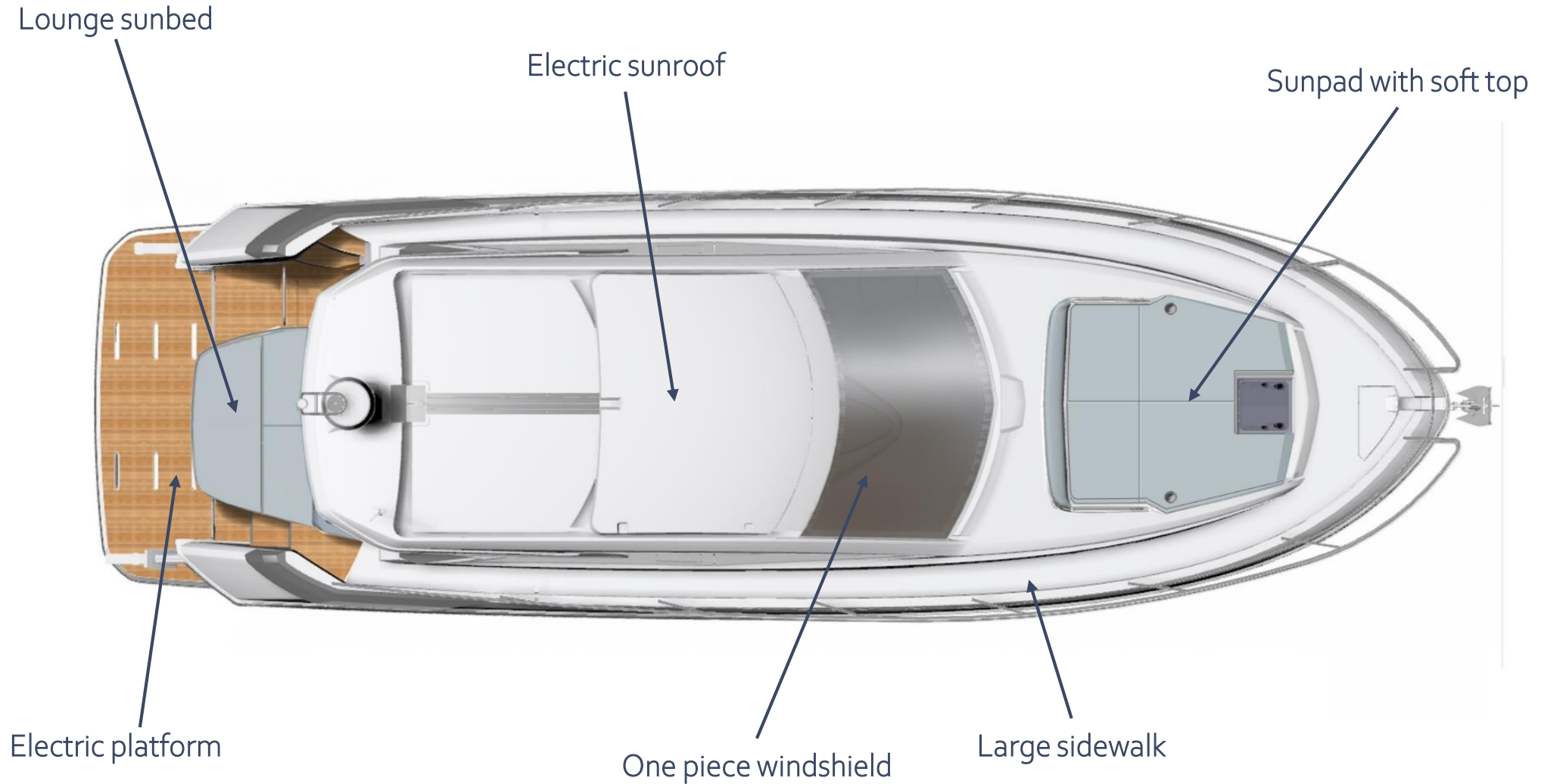

GRAN TURISMO 41



Standard electric opening sunroof

Metallic grey painted fashion plate

Large wheelhouse windows

Sunpad with canopy

Opening sliding windows

Large hull windows with opening portholes

GRAND TURISMO 41

Comfortable 6 persons cockpit

Large electric platform

Large sidewalk

Large sunbed



GRAN TURISMO 41



Panoramic
wheelhouse
windows

Sunbath with
soft top

Opening
portholes

GRAN TURISMO 41

Exterior -Key Points



Retractable canopy

Folding backrest

Cup holders

Comfortable and safe sunpad

GRAN TURISMO 41

Exterior -Key Points

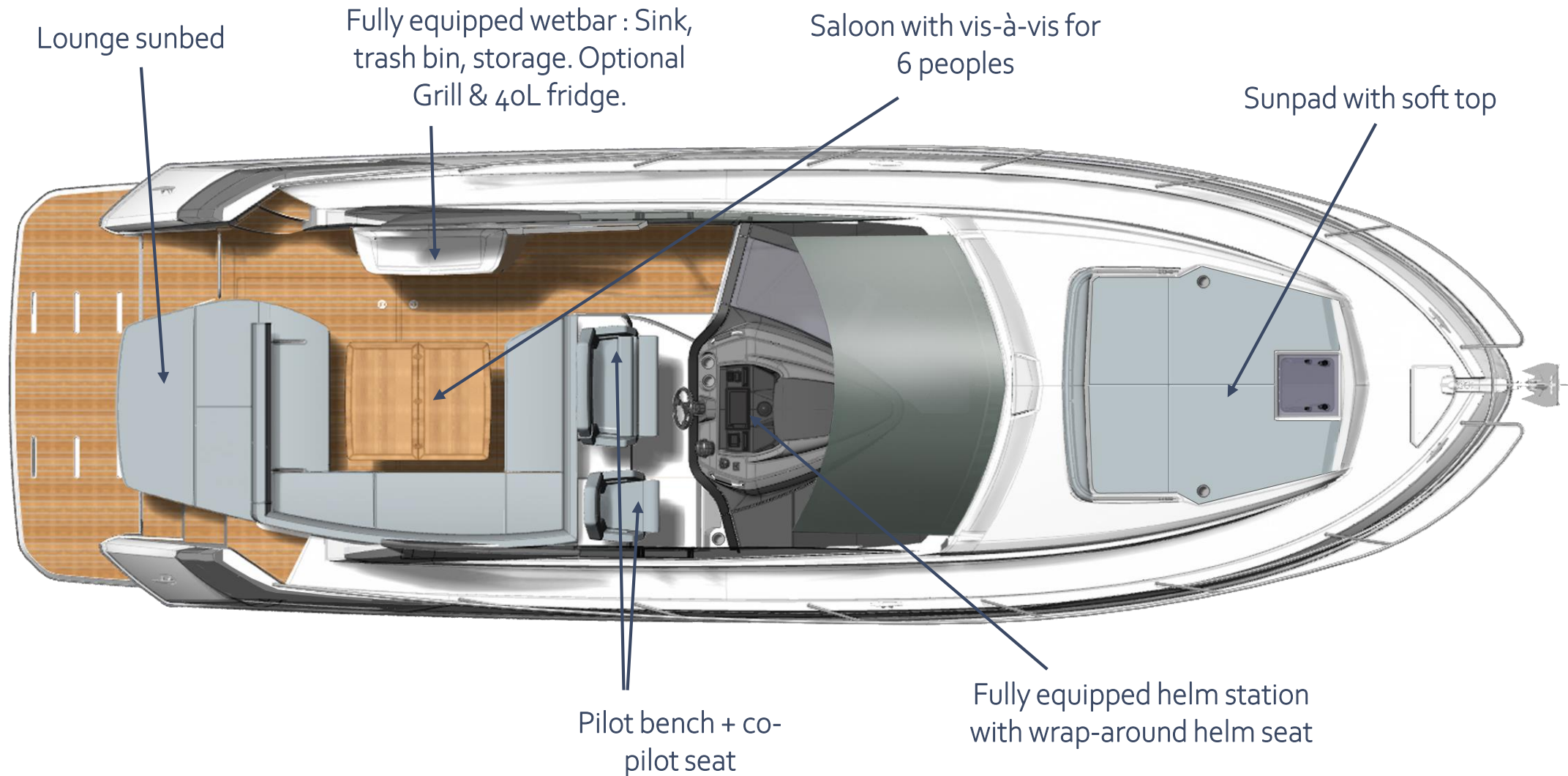

GRAN TURISMO 41

Folding backrest

Lounge aft sunbed

Four cup holders



GRAN TURISMO 41

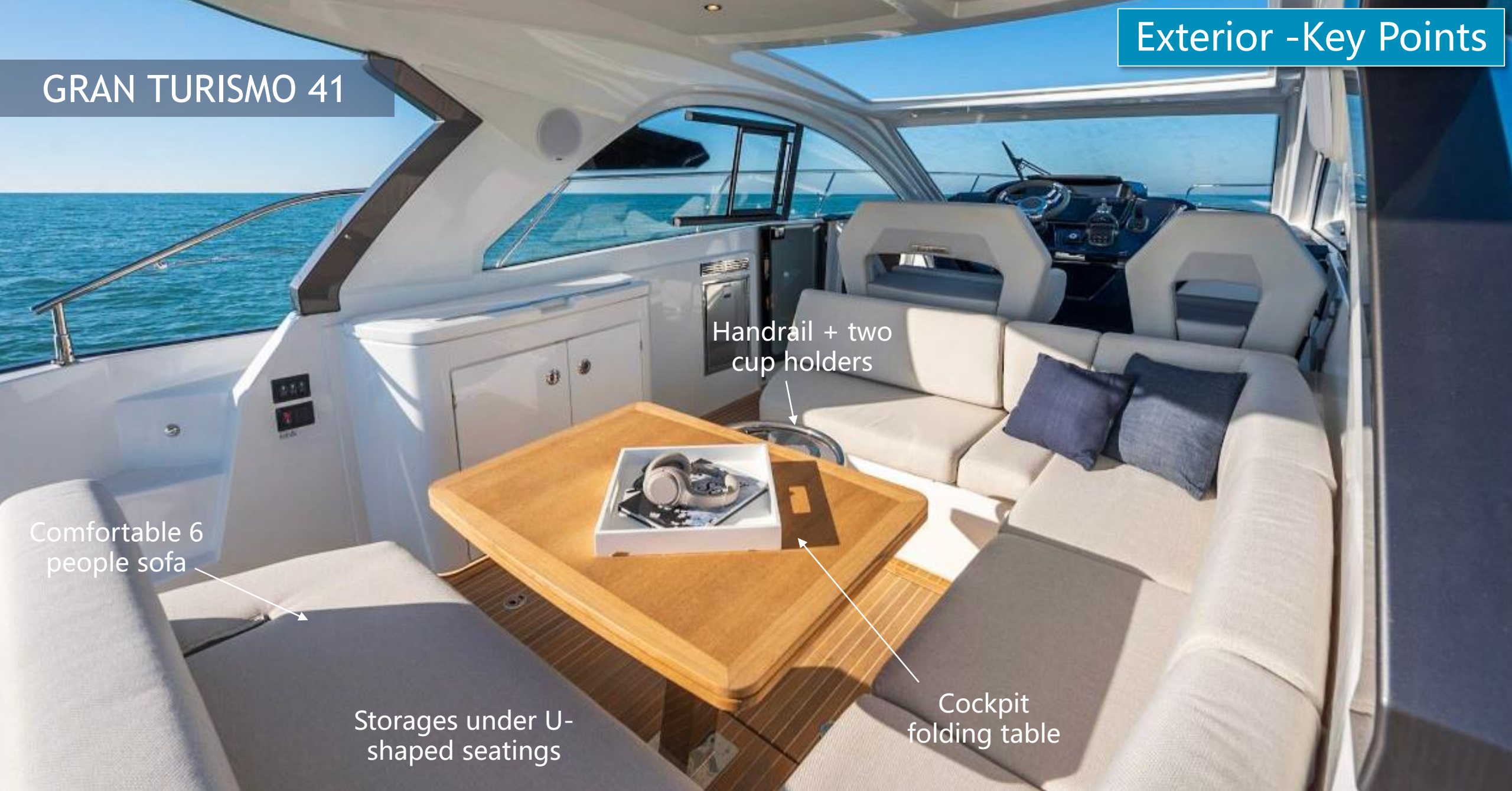

Handrail + two cup holders

Comfortable 6 people sofa

Storages under U-shaped seatings

Cockpit folding table

GRAN TURISMO 41

Optional fridge

Sliding bench seat

Handrail + two cup holders

Removable sofa - Easy access to the co-pilot seat



Exterior -Key Points

GRAN TURISMO 41



Full equipped wet bar

Optional grill

Sink

Storage

Led pack ambiance

Optional fridge



Optional Icemaker

Trash bin

Exterior -Key Points



Garmin screen

Compass

Joystick

Bow thruster

Gauges

Throttles

VHF

Cup holders (x3)

Stainless steel steering wheel

GRAN TURISMO 41

Measures given in millimetres

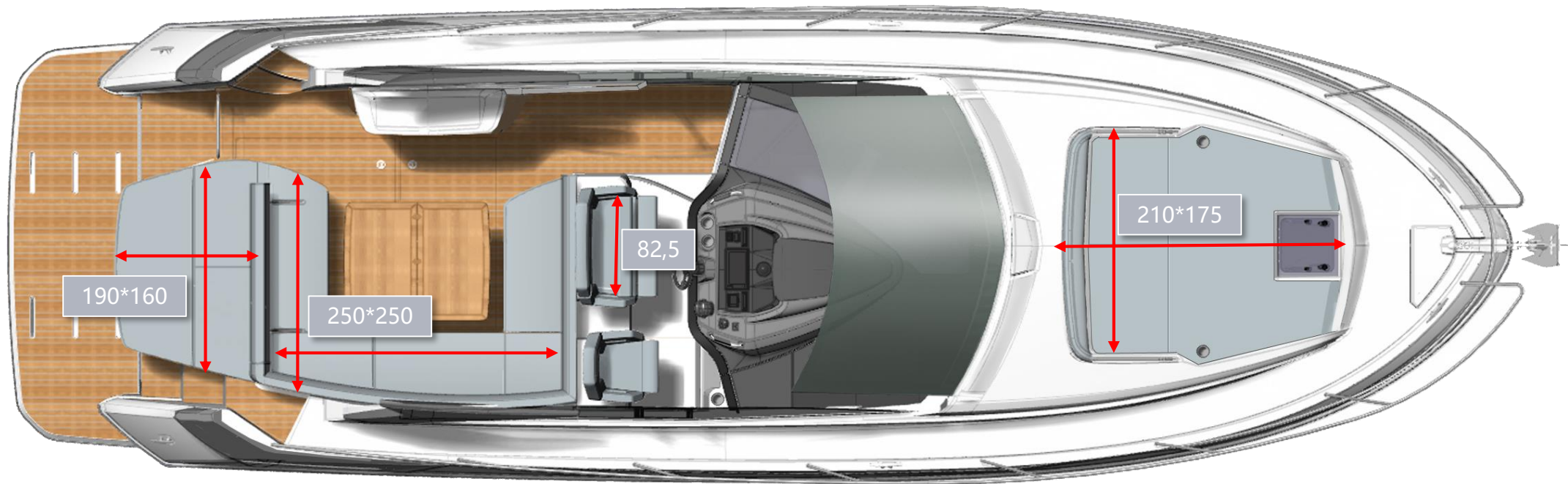

The image shows the interior of a yacht's lower deck. In the foreground, there is a light-colored wooden dining table with a white tray holding two glasses. To the right, a grey upholstered sofa with dark blue cushions is visible. In the background, there is a control panel with various switches and a large window overlooking the water. The overall atmosphere is modern and luxurious.

KEY SELLING POINTS

LOWER DECK

New layout for GRAN TURISMO 41

Interior -Key Points Wheelhouse

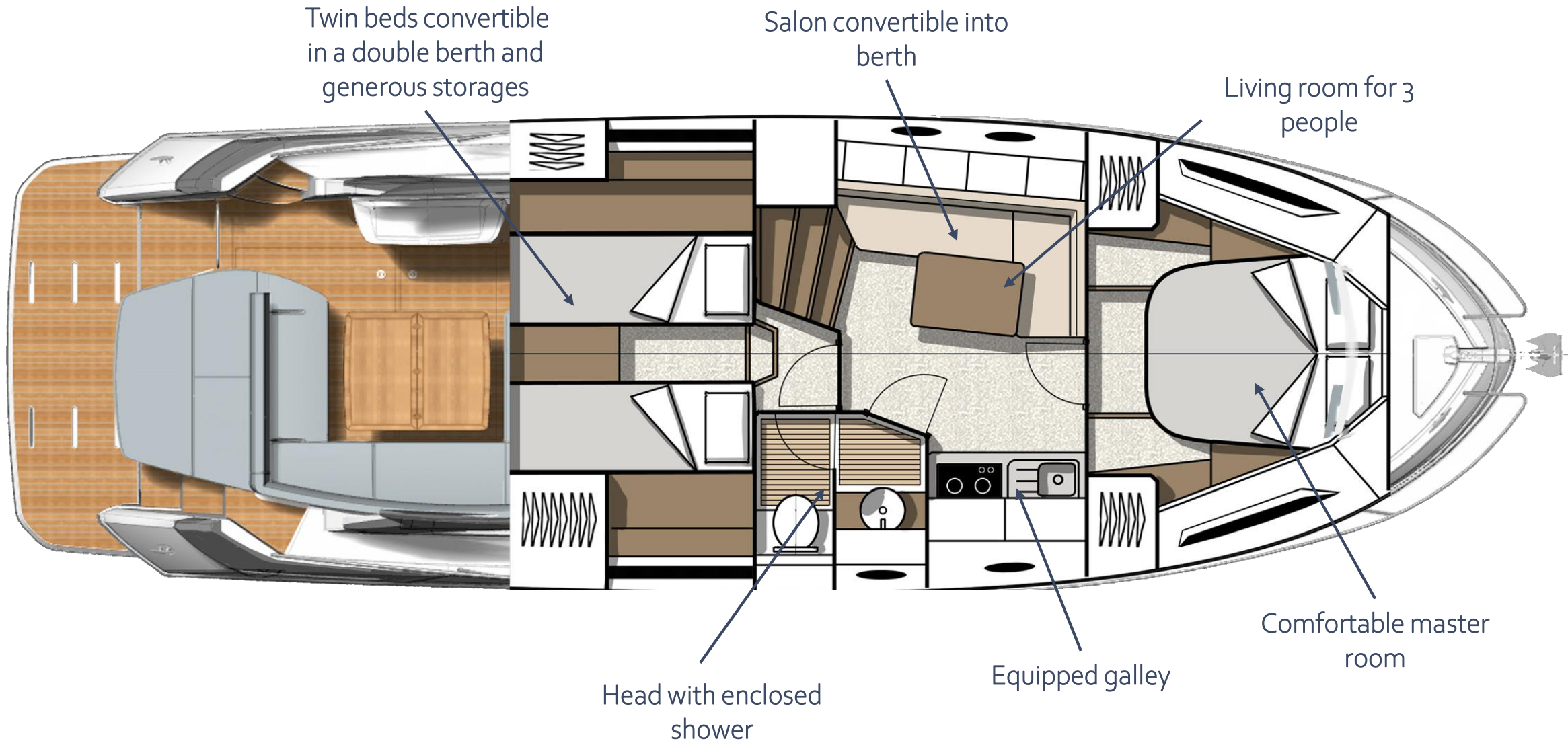

Interior -Key Points Salon



Optional grey walnut in the lower deck (new wood)

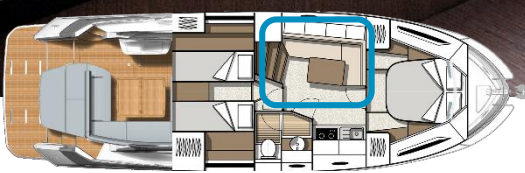

Interior -Key Points Wheelhouse

Storages

Panoramic window + porthole

Mirror + lacquered
cupboards doors pack
ambiance

Large saloon including
many storages

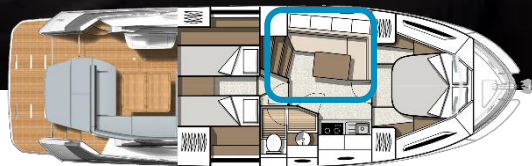

Interior -Key Points Wheelhouse

Sofa convertible in a
single berth - 2,10*2m

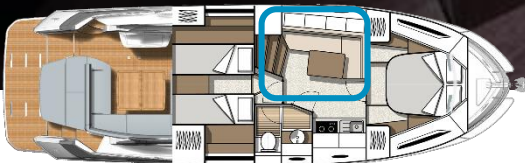

Interior -Key Points Wheelhouse

Large storages

Optional 80L microwave
emplacement

Electric baking tray
(option)

Sink

Large window with
porthole

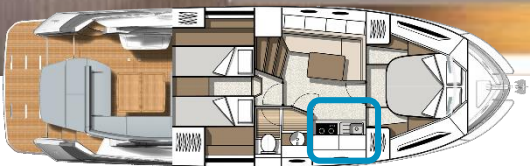

Interior -Key Points Wheelhouse

Opening skylight

TV emplacement

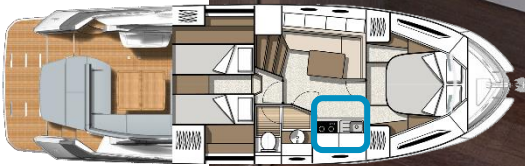

Trash can

Fridge
80L

Multiple drawers and
storages

Interior -Key Points Master Room

Opening
Skylight



Large hull windows with
opening portholes –
Panoramic view



Large bed



Interior -Key Points Guest Room



Storage

Storage

Twins beds convertible in double bed

Storage

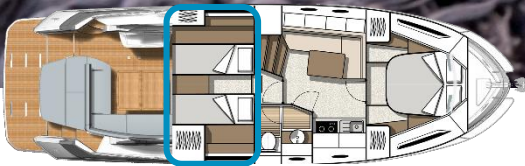



Reading lights

Panoramic view at sea + cross ventilation

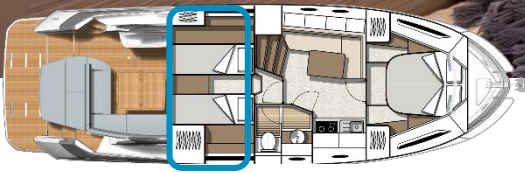

Interior -Key Points Guest Room



Spacious storage (x2)

Interior -Key Points Day Head

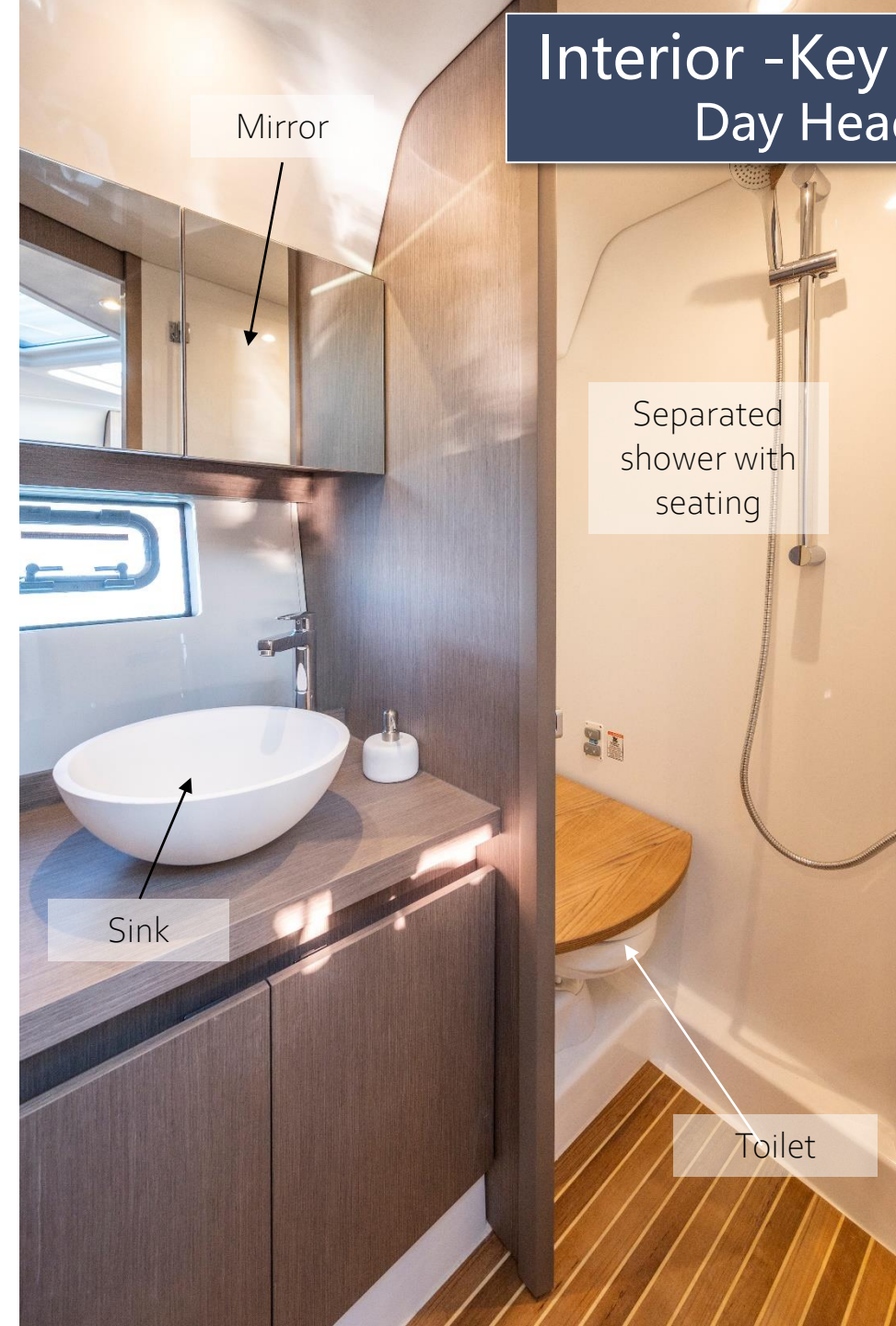

Interior -Key Points Beds

Measures given in millimetres

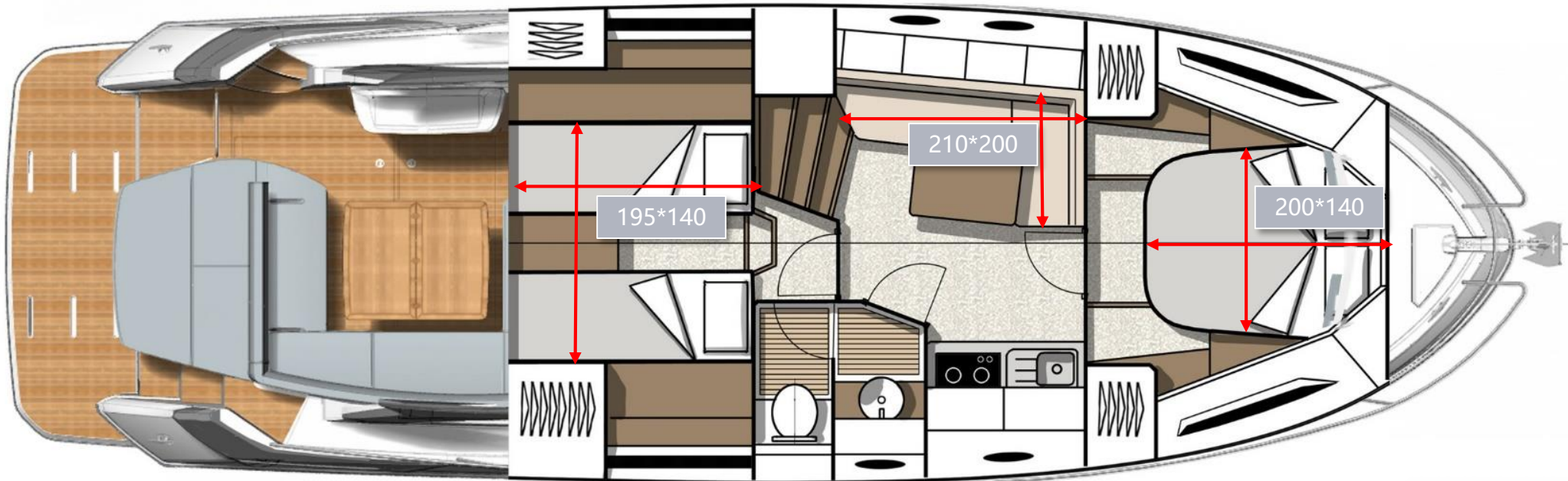

ELECTRICAL & USB OULETS COCKPIT

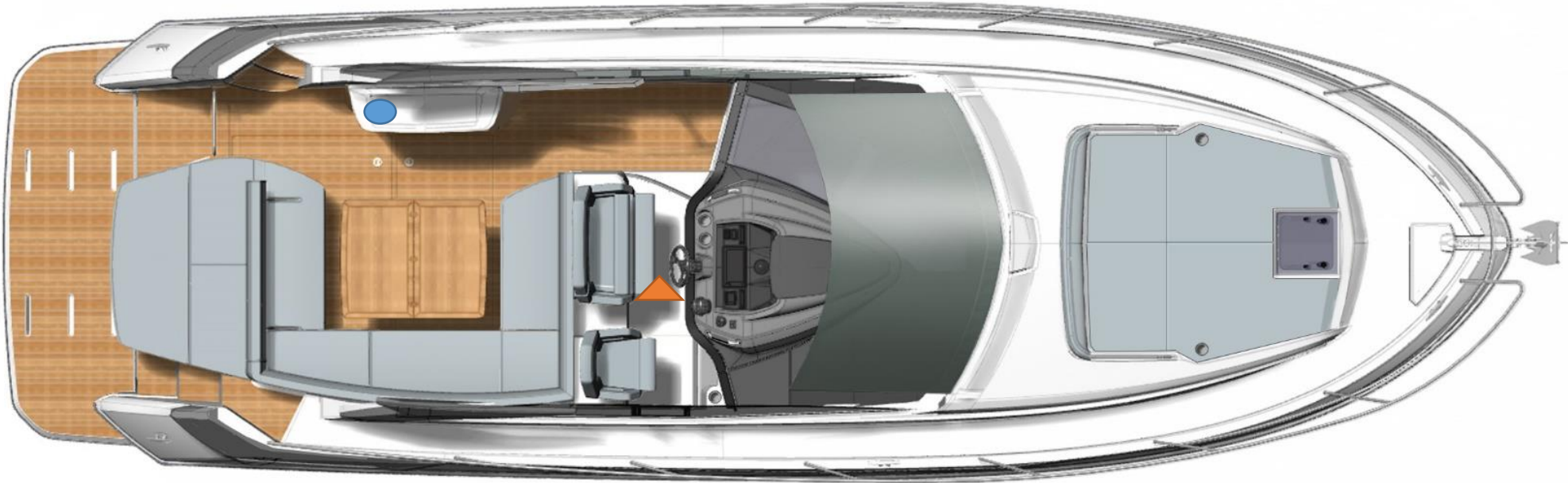

- Electrical outlet
- ▲ USB outlet

ELECTRICAL & USB OULETS LOWER DECK

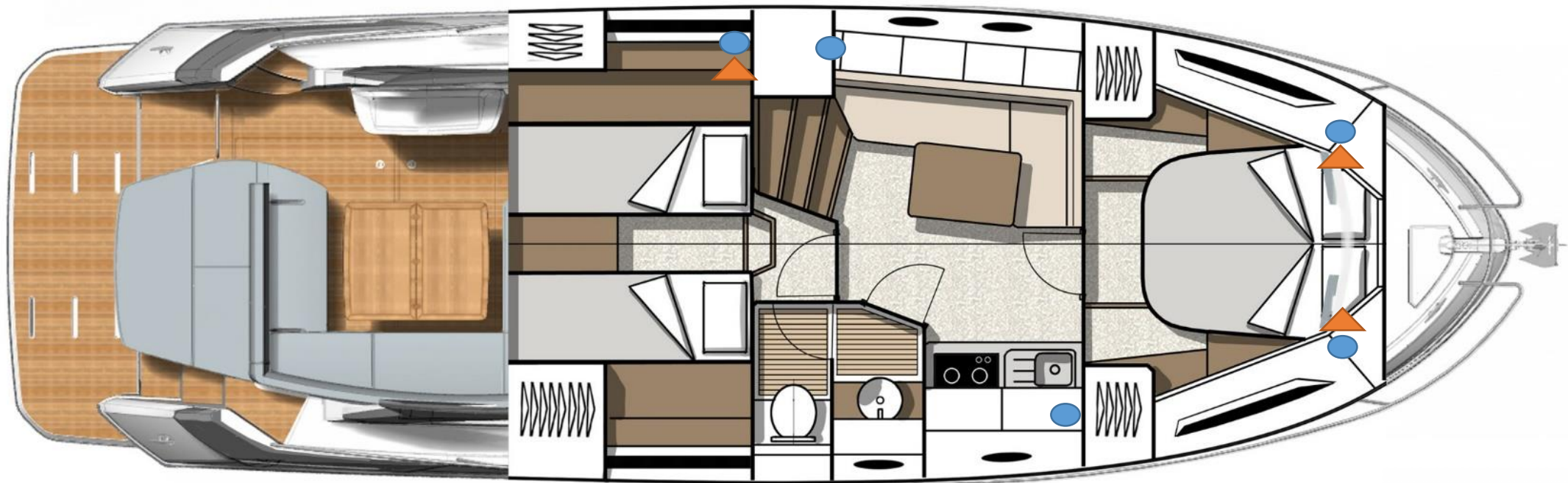

- Electrical outlet
- ▲ USB outlet

AIR CONDITIONING COCKPIT

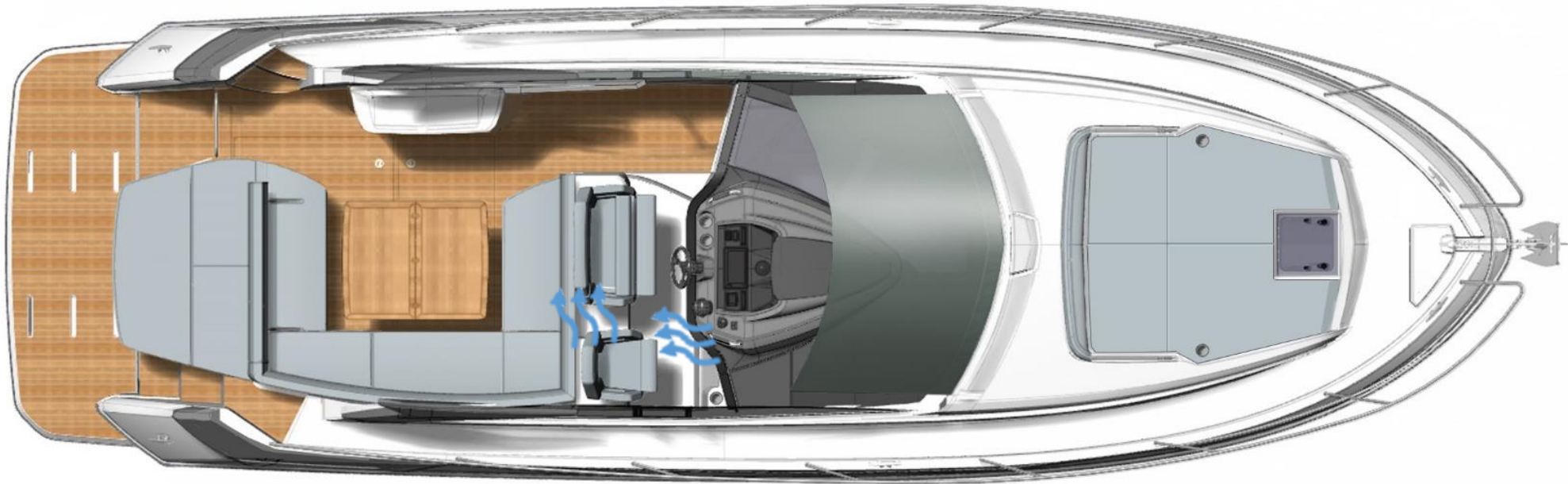

AIR CONDITIONING LOWER DECK

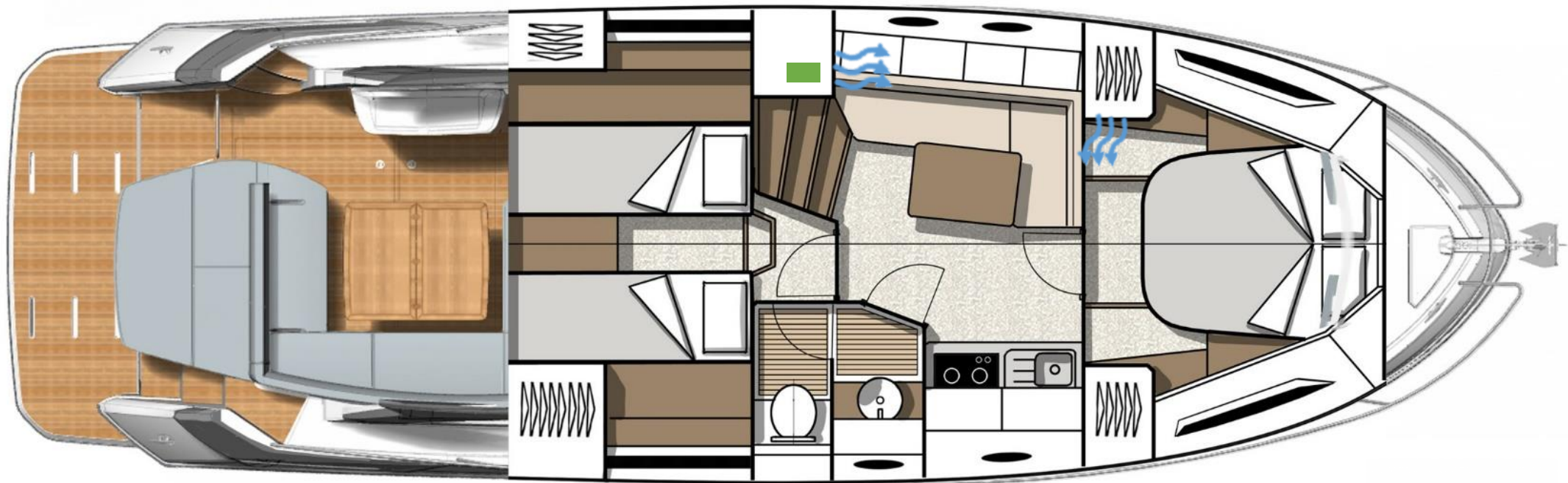

 A/C Vents

 Control

AIR HEATING LOWER DECK

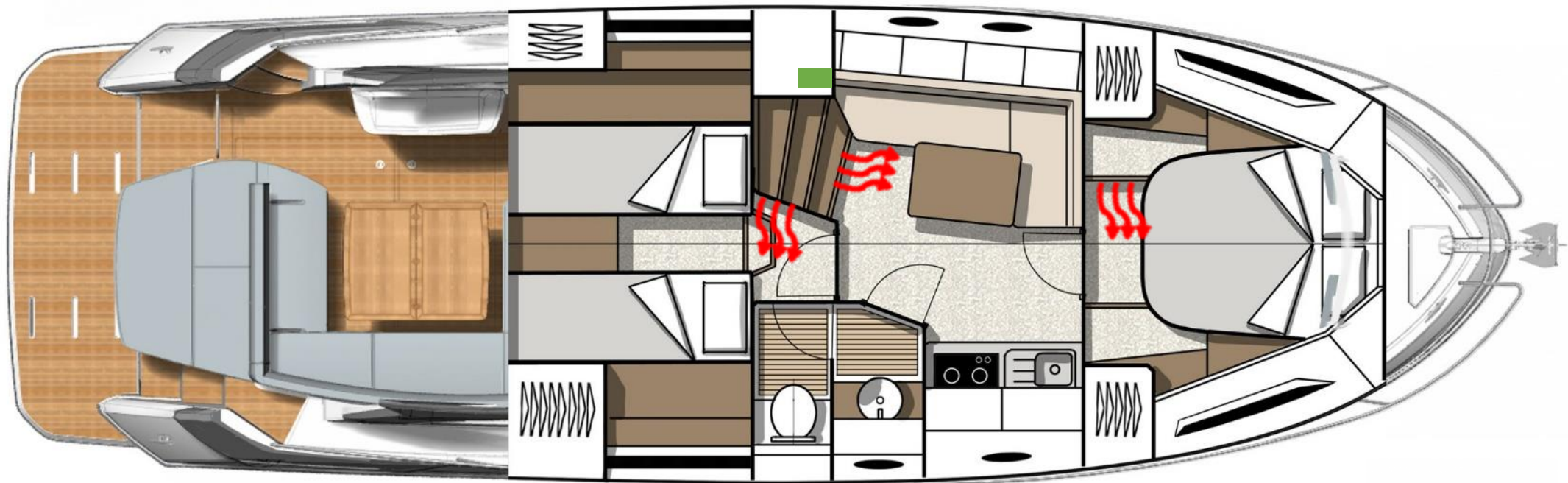

 Heating vents

 Control

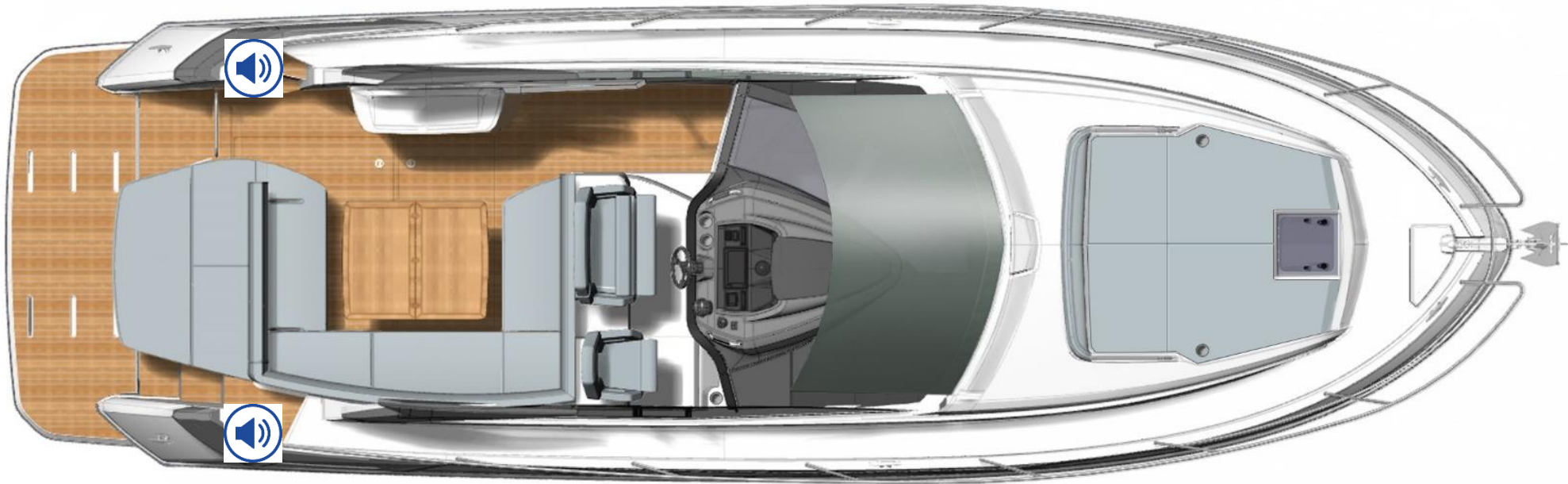

AUDIO VISUAL COCKPIT

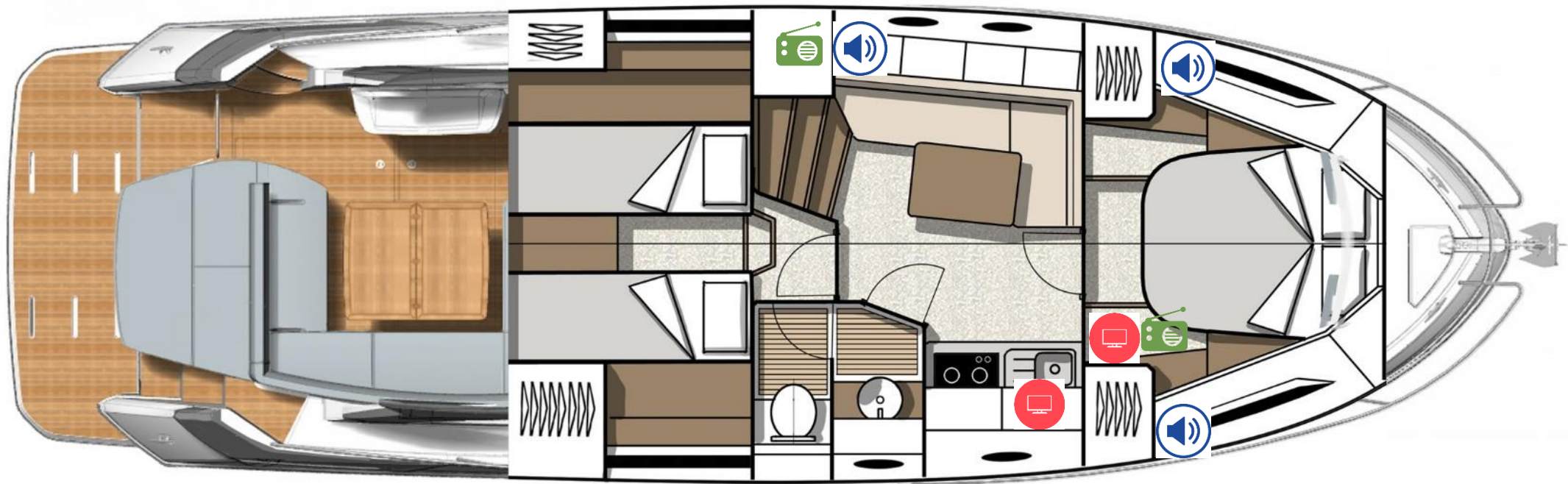

 Speakers

AUDIO VISUAL LOWER DECK



-  Speakers
-  TV emplacement
-  Control Radio

PERFORMANCES VOLVO 2 X 300 CV

GRAN TURISMO 41

GT3XB - GRAN TURISMO 41

Caractéristiques / Specifications :

2 X VOLVO D4-300 Helices/Propellers H5

FUEL TANK : 2 x 325L / 2 X 86 US gal

Déplacement total du bateau testé / Total displacement of boat tested: 9 713kg / 21 414 LBS

Regime en tours par minute au tableau de bord / RPM on instrument panel	Vitesse en nœuds moyenne au radar / Average speed on the radar in knots	Consommation en litres par heure total / consumption in liter per hour total	Rendement / Efficiency (NM/L)	Consommation totale en USGal / heure Total consumption in GPH	Rendement / Efficiency (NM/USGal)	Autonomie en NM (avec réserve 20%) /Range in NM (with 20% fuel supply)
Ral	4	2,3	1,74 NM	0,6 USGal	6,6 NM	904,35 NM
1000	6,1	7,2	0,85 NM	1,9 USGal	3,2 NM	440,56 NM
1500	8,2	16,6	0,49 NM	4,4 USGal	1,9 NM	256,87 NM
2000	9,8	40,2	0,24 NM	10,6 USGal	0,9 NM	126,77 NM
2500	13,9	65,8	0,21 NM	17,4 USGal	0,8 NM	109,85 NM
2800	18,8	73,4	0,26 NM	19,4 USGal	1,0 NM	133,19 NM
3000	23	79	0,29 NM	20,9 USGal	1,1 NM	151,39 NM
3200	26,4	86,6	0,30 NM	22,9 USGal	1,2 NM	158,52 NM
3400	29,2	98,4	0,30 NM	26,0 USGal	1,1 NM	154,31 NM
3500	30,5	104,6	0,29 NM	27,6 USGal	1,1 NM	151,63 NM
3600	31,8	111,7	0,28 NM	29,5 USGal	1,1 NM	148,04 NM
3630	32,1	115,5	0,28 NM	30,5 USGal	1,1 NM	144,52 NM

PERFORMANCES

VOLVO 2 X 380 CV

GRAN TURISMO 41

GT3XB - GRAN TURISMO 41

Caractéristiques / Specifications :

2 X VOLVO D6-380 Hélices/Propellers H6

FUEL TANK : 2 x 325L / 2 X 86 US gal

Déplacement total du bateau testé / Total displacement of boat tested: 10 245kg / 22 586 LBS

Regime en tours par minute au tableau de bord / RPM on instrument panel	Vitesse en nœuds moyenne au radar / Average speed on the radar in knots	Consommation en litres par heure total / consumption in liter per hour total	Rendement / Efficiency (NM/L)	Consommation totale en USGal / heure Total consumption in GPH	Rendement / Efficiency (NM/USGal)	Autonomie en NM (avec réserve 20%) /Range in NM (with 20% fuel supply)
Ral	4	6	0,67 NM	1,6 USGal	2,5 NM	346,67 NM
1000	6,2	12,4	0,50 NM	3,3 USGal	1,9 NM	260,00 NM
1500	8,7	24,6	0,35 NM	6,5 USGal	1,3 NM	183,90 NM
2000	11,1	52	0,21 NM	13,7 USGal	0,8 NM	111,00 NM
2500	20	80,8	0,25 NM	21,3 USGal	0,9 NM	128,71 NM
2800	26,3	90,6	0,29 NM	23,9 USGal	1,1 NM	150,95 NM
3000	29,3	103,6	0,28 NM	27,4 USGal	1,1 NM	147,07 NM
3200	31,8	120,2	0,26 NM	31,8 USGal	1,0 NM	137,57 NM
3400	34,5	141,2	0,24 NM	37,3 USGal	0,9 NM	127,05 NM
3500	35,6	149	0,24 NM	39,4 USGal	0,9 NM	124,24 NM
3600	37,4	159,4	0,23 NM	42,1 USGal	0,9 NM	122,01 NM
3611	37,4	160,7	0,23 NM	42,5 USGal	0,9 NM	121,02 NM